

**KENNEWICK IRRIGATION DISTRICT
RESOLUTION 2017-32**

DECLARING SURPLUS REALTY

and

**AUTHORIZING THE MARKETING FOR SALE OR LEASE OF
REAL PROPERTY (FINLEY AREA),
KID #9113, #9123, #9133, #9143, #9104
#9114, #9124 AND #9115**

WHEREAS, the Board of Directors of Kennewick Irrigation District met
In regular session on September 5, 2017 with a quorum present, and

WHEREAS, the District determined it has realty that is no longer necessary or needed,
for the use of the District and it would be in the best interest of the District that said realty be
declared surplus and sold or leased; and

WHEREAS, the Directors of the District have determined that said realty should be
surplused and marketed for sale or lease in accordance with RCW 87.03.136; and

WHEREAS, the Directors of the District have authorized the marketing of said
property to be sold or leased at a price determined by the Board to be not less than the
reasonable market value of the property; subject, however, to those adjustments allowed under
RCW 87.03.136; and

WHEREAS, the Directors of the District have determined that any sales shall be
determined by negotiation for the best and highest value and that any lease shall be determined
by auction for the best and highest bid and the actual approval of any transaction, whether sale
or lease, and its related terms, shall require further action and resolution of the Board.

NOW, THEREFORE, BE IT RESOLVED that the Directors of the District have
determined the described real property on **Attachment "A"** is not necessary or needed for the
use of the District and hereby authorizes the marketing and sale or lease of the property in
accordance with RCW 87.03.136.

Resolution 2017-32 is hereby adopted by the Board of Directors of the Kennewick
Irrigation District, Benton County, Washington, at a meeting with a quorum present in open
public session thereof, this 5th day of September, 2017.

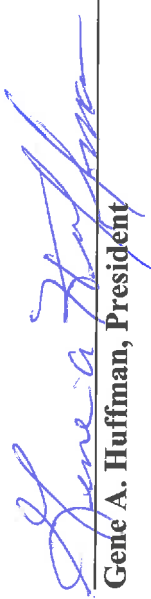
Gene A. Huffman, President

Dean Dennis, Vice President

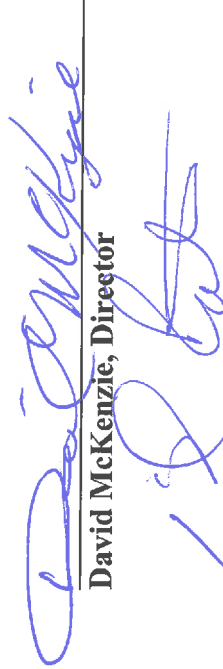
David McKenzie, Director

Jim Holmes, Director



Kirk Rathbun, Director

ATTACHMENT "A" RESOLUTION 2017-32

Property is located in Benton County, State of Washington, and is legally described as follows:

KID Property #	Parcel Number	Acre Size	Legal Description
9113	127803013363001	13.84	SECTION 27, TOWNSHIP 8 NORTH, RANGE 30 EAST, QUARTER SW: SHORT PLAT #3363, LOT 1, RECORDED IN VOLUME 1 OF SHORT PLATS, PAGE 3363, RECORDS OF BENTON COUNTY, WASHINGTON. (AF#2012-021481, 7/19/2012).
9123	127803013363002	1.11	SECTION 27, TOWNSHIP 8 NORTH, RANGE 30 EAST, QUARTER SW: SHORT PLAT #3363, LOT 2, RECORDED IN VOLUME 1 OF SHORT PLATS, PAGE 3363, RECORDS OF BENTON COUNTY, WASHINGTON. (AF#2012-021481, 7/19/2012).
9133	127803013363003	50.53	SECTION 27, TOWNSHIP 8 NORTH, RANGE 30 EAST, QUARTER SW: SHORT PLAT #3363, LOT 3, RECORDED IN VOLUME 1 OF SHORT PLATS, PAGE 3363, RECORDS OF BENTON COUNTY, WASHINGTON. (AF#2012-021481, 7/19/2012). SECTION 27, TOWNSHIP 8 NORTH, RANGE 30 EAST, QUARTER SW: SHORT PLAT #3363, LOT 4, RECORDED IN VOLUME 1 OF SHORT PLATS, PAGE 3363, RECORDS OF BENTON COUNTY, WASHINGTON. (AF#2012-021481, 7/19/2012).
9143	127803013363004	89.65	SECTION 27, TOWNSHIP 8 NORTH, RANGE 30 EAST, QUARTER SW: SHORT PLAT #3363, LOT 4, RECORDED IN VOLUME 1 OF SHORT PLATS, PAGE 3363, RECORDS OF BENTON COUNTY, WASHINGTON. (AF#2012-021481, 7/19/2012).
9104	134801013367001	60.64	SECTION 34, TOWNSHIP 8 NORTH, RANGE 30 EAST, QUARTER NE: SHORT PLAT #3367, LOT 1, RECORDED IN VOLUME 1 OF SHORT PLATS, PAGE 3367, RECORDS OF BENTON COUNTY, WASHINGTON. AF#2012-026013, 8/24/2012.
9114	127804010772002	16.83	SHORT PLAT 772, LOT 2: TOGETHER WITH VACATED ROAD ROW RESOLUTION (DESCRIPTION CHANGE AF#2011-034938, 12/09/2011)
9124	134801013367002	1.71	SECTION 34, TOWNSHIP 8 NORTH, RANGE 30 EAST, QUARTER NE: SHORT PLAT #3367, LOT 2, RECORDED IN VOLUME 1 OF SHORT PLATS, PAGE 3367, RECORDS OF BENTON COUNTY, WASHINGTON. AF#2012-026013, 8/24/2012.
9115	127804000002000	80.95	THE PORTION OF SECTION 27, TOWNSHIP 8, RANGE 30 DEFINED AS FOLLOWS: THE NORTHEAST OF THE SOUTHEAST, SOUTHWESTERLY OF CANAL. THE NORTHWEST OF THE SOUTHEAST, SOUTHWESTERLY OF CANAL, LESS THE WEST 30.00F
TOTAL ACRES		315.26	

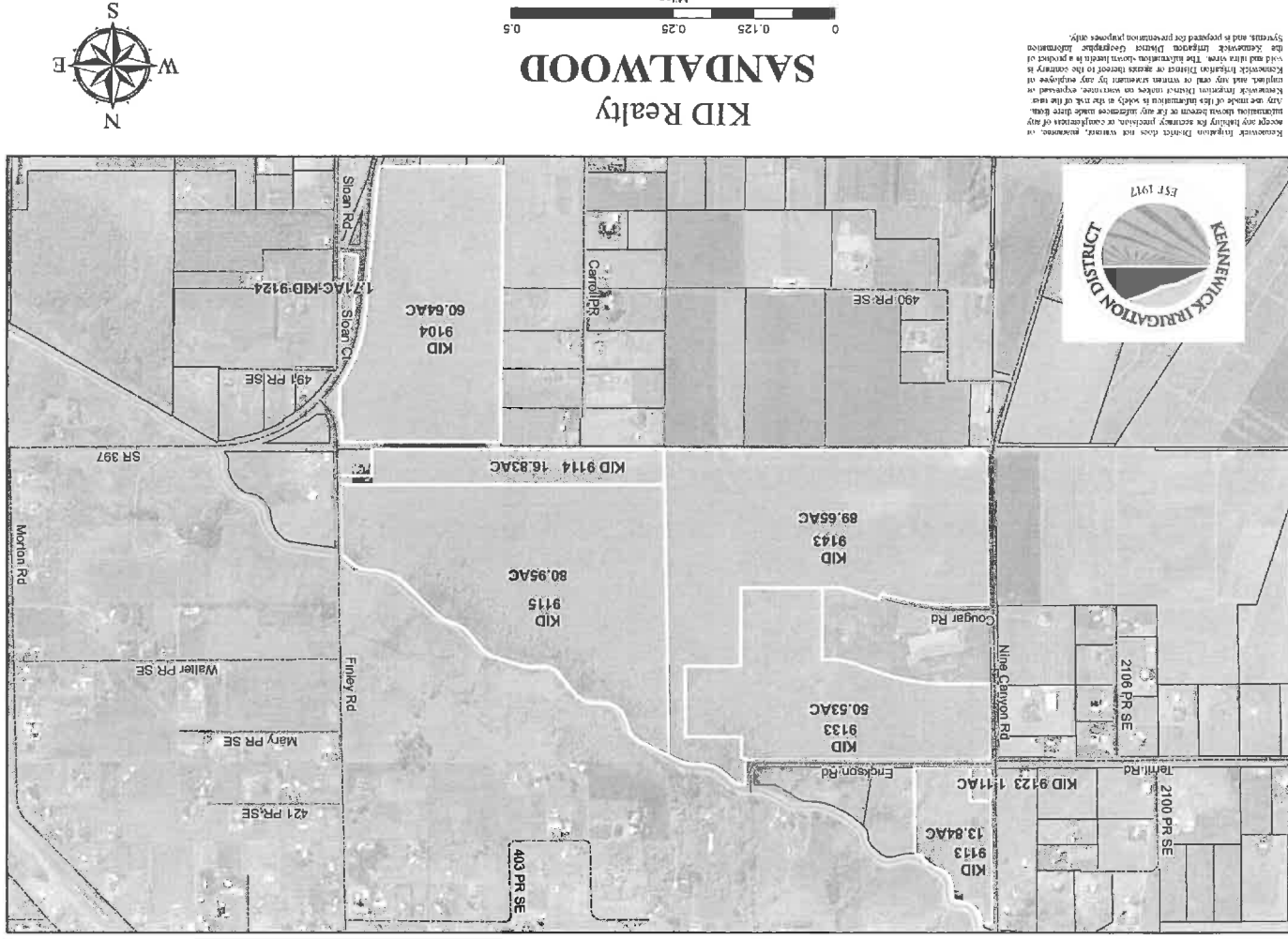
After Recording Mail to:
 KENNEWICK IRRIGATION DISTRICT REALTY
 2015 S ELY ST
 KENNEWICK, WA 99337



KID Realty
SANDALWOOD

Kennewick Irrigation District does not warrant, guarantee, or accept any liability for accuracy, precision, or completeness of any information derived hereon or for any judgments made here from. Any use made of this information is solely at the risk of the user. Kennewick Irrigation District makes no warranty, expressed or implied, and any use of this information by any employee of Kennewick Irrigation District or anyone thereof is a product of the Kennewick Irrigation District Geographic Information System, and is prepared for presentation purposes only.